Product Specification

Name: Dimming Touch Controller

Model: RC-40



Summarization

Dimming touch controller is a high-end touch controller which adopts latest capacitive trigger and wireless technology. The controller has features such as large current, low power consumption; remote control adopts high precision capacitance touch control chip, has color ring and buttons function, increases the touch sensitivity, reduces trigger which caused by mistake. You can use remote control to dim the strips. It has advantages such as far control distance, high touch sensitivity, strong driving ability, stability and so on. The product can control a variety of lamp whose source of light is LED. For instance, point source of light, flexible light strip, panel light etc.

Technical Parameters

Controller

Supply voltage: DC12-24V

Working current: $\leq 8A/CH$

Connection method: Common anode

External dimension: L83*W79*H33 mm

Static power consumption: $< 1W$

Output power: DC12V: $< 288W$, DC24V: $< 576W$ (with short circuit protection function)

Output frequency: 300Hz

Remote Control

Working temperature: -20-60°C

Power supply mode: AAA * 3

Supply voltage: 1.5V * 3

Standby power consumption: 0.025Mw

Static current: 85Ua

Working current: 26mA

Remote distance: > 20m

Standby time: >6 months

External Dimension (mm)

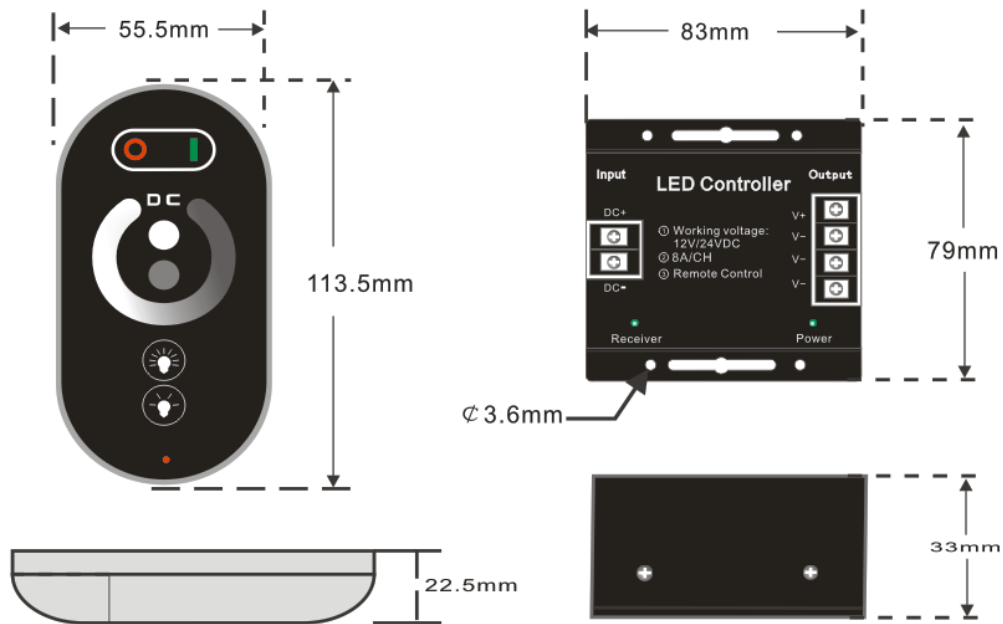

Interface specification

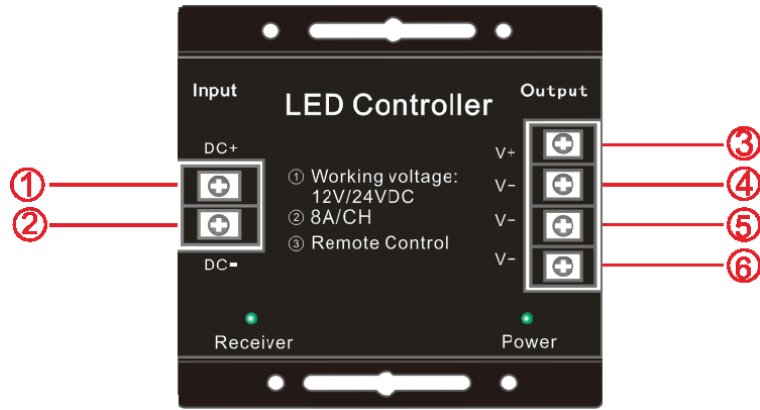

“o,1” “o,2” : Power input interface, input voltage range is DC12-24V, “o,1” is positive electrode, “o,2” is negative electrode;

“o,3” “o,4” “o,5” “o,6”: Power output interface, output voltage is 12-24V, max. output current is 8A, “o,3” is positive electrode, “o,4” “o,5” “o,6” are output channels.

Instruction for use

Function of controller and remote control:



: ON/OFF key, it is used for lighting on/off LED strips.



: Mode switch button, it is used for controlling increase and reduce the brightness from 2% to 100%.



: brightness adjust ring, when touching a certain point on the color ring, LED strip will show the color of color ring at this time.



: Brightness button, it is used to increase or reduce brightness./

Instruction for matching code of remote control : When power on, close to the controller, at the same time press the ON/OFF key of remote control, long press this key in 3s to match code. The load light will flicker after matching code success.

Typical application

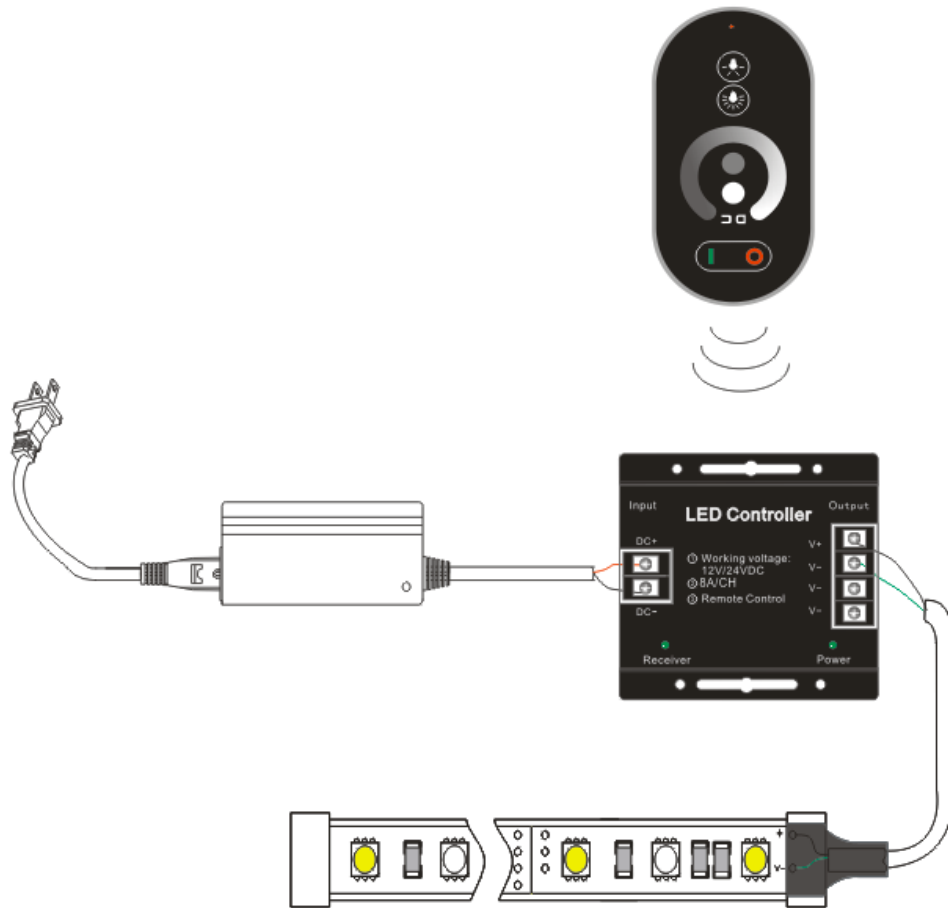

Remarks

1. Connect the load wire at first, following by the power wire; **Please ensure short circuit can not occur between connecting wire before you turn on the power.**
2. Power supply voltage range is DC12-24V, more than voltage range maybe burn out the controller.
3. Stop to use for more than 30s, the remote control will enter the standby state, then the color ring will fail, The next time use, just click the button on remote control, then remote control will be reawakended.