

Solo Mech

Hingeless Single Lift-Up Door Mechanism

*Simply Perfect,
Completely Nature*



samet



Outstanding Design Results In Magical Movement and Pure Silence

Solo-Mech ensures flawless “open and close” movement with innovative “hinge-less” technology.





MOCHA



ANTHRACITE



GREY



WHITE

Provides great colour alternatives with Anthracite, Mocha, Grey and White colour options.



**Soft and silent movement
features provide maximum
comfort.**

With its gradual-open mechanism,
cabinet doors can be stopped at a
desired level.

“Fully mechanic”
lifting structure provides
lifetime stability.





UP
DOWN



LEFT
RIGHT



BACK
FORWARD

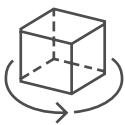

3D Adjustment

Solo-Mech's three dimensional alignment mechanism enables flawless installation.

Solo-Mech Aluminium Frame Solution



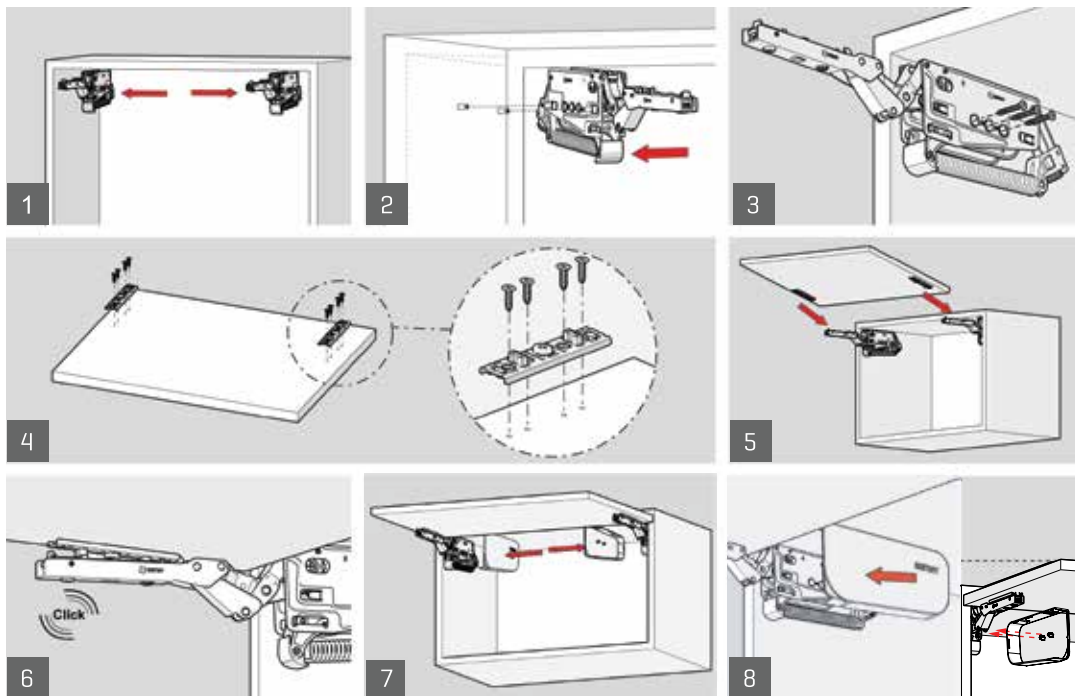

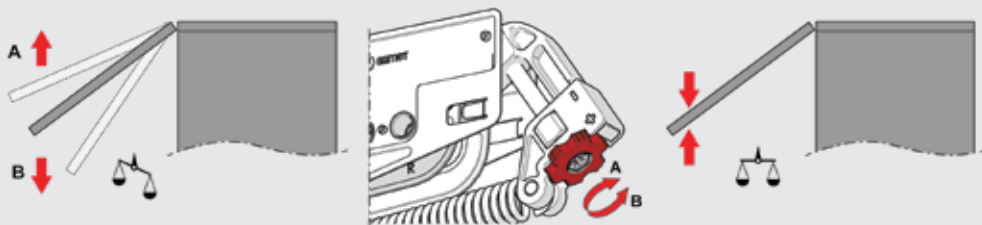

If, when the door is released, it rises instead of remaining in position, turn in direction "A," and if it descends, turn in direction "B" in order to adjust balance.

Low braking at setting 1, High braking at setting 4.

If the door closes too fast or too slowly, you can adjust the strength of the soft closing mechanism by adjusting from the specified position.

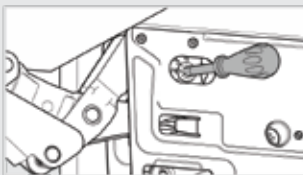

Important: Do not force the adjustment mechanism beyond the end point.

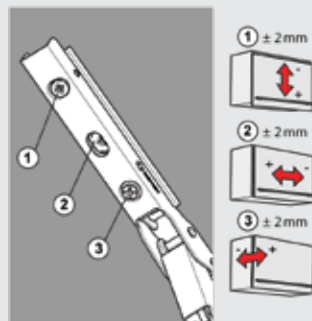

SAFETY INFORMATION

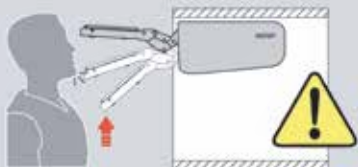

Caution:
Lever arm can
spring up and
cause injury.

DESCRIPTION	CODE
Solo-Mech Aluminium Framed Door Connector	1249910

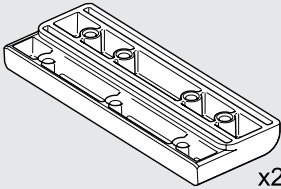

x10
M4
[DIN 7500M]

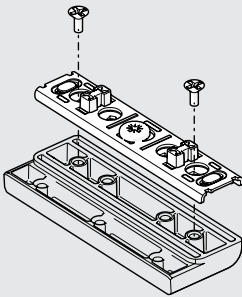

1

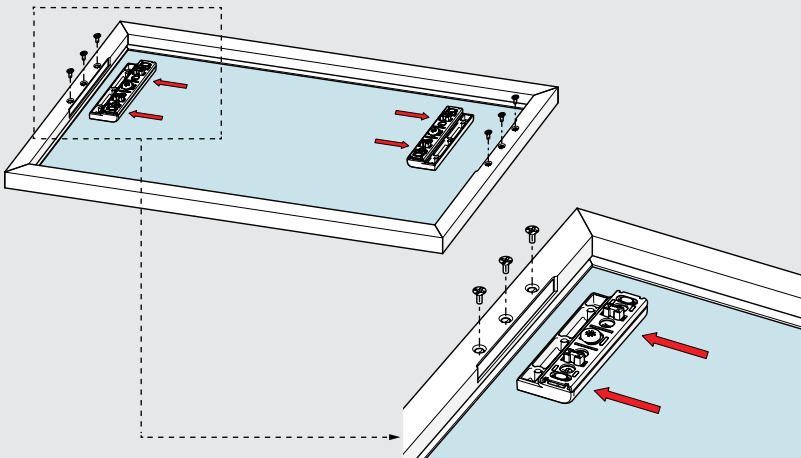
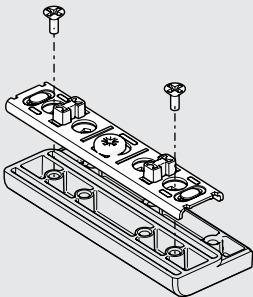

2

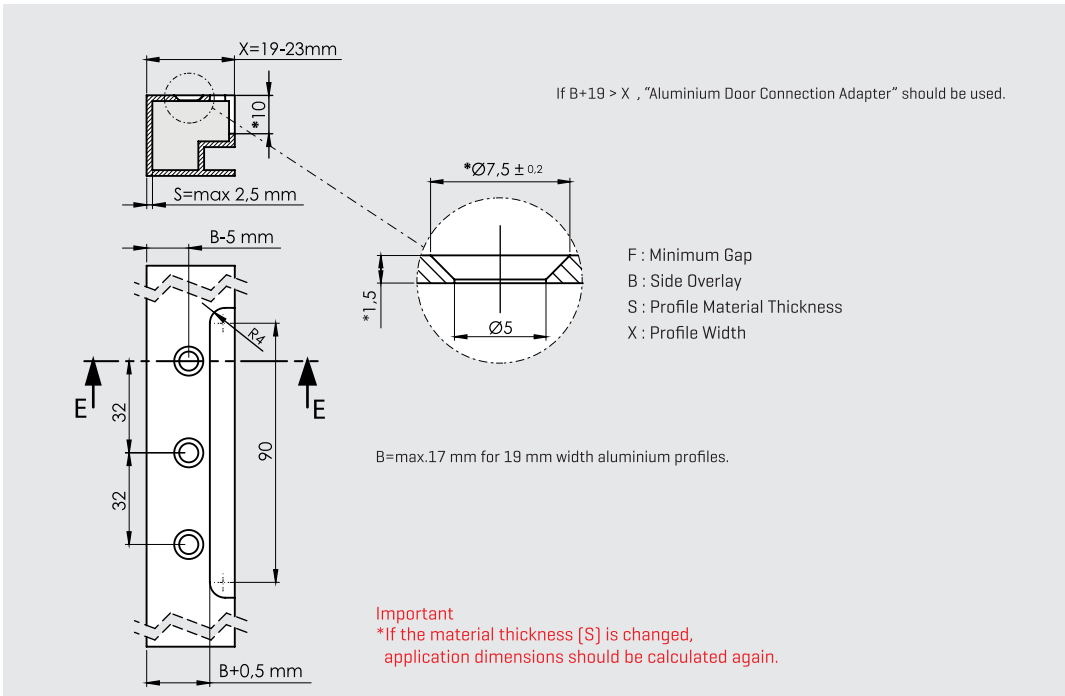
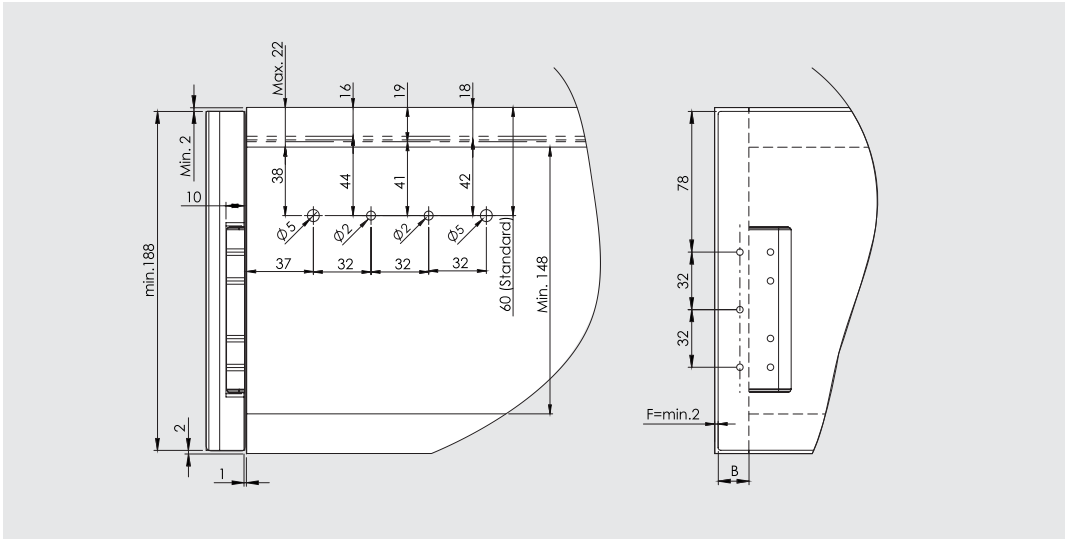

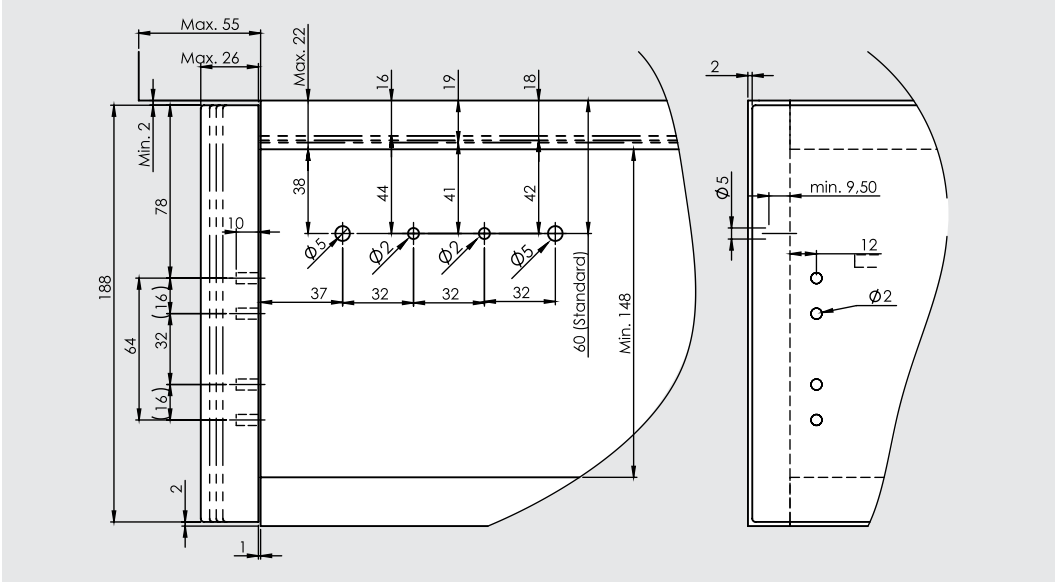

DOOR HEIGHT	POWER UNIT	A1		B1		C1	
		min. kg	max. kg	min. kg	max. kg	min. kg	max. kg
200 mm		3,6	6,5	5	9,7	7	14,7
201-250 mm		3,4	5,3	4	7,5	5,5	12,2
251-300 mm		1,9	4,9	3	5,9	4,5	9,9
301-350 mm		1,6	3,6	2,8	5	4	7,9
351-400 mm		1,4	3,1	2,4	4,2	3,6	7,2
401-450 mm		1,3	2,8	2,2	3,8	3,2	6,3
451-500 mm		1,2	2,5	2	3,4	2,8	5,5
501-550 mm		1	2,2	1,75	3	2,6	5,1
551-600 mm		0,95	2	1,7	2,8	2,5	4,6

More powerful mechanism is recommended for intersection areas.